

READ ALL INSTRUCTIONS BEFORE BEGINNING INSTALLATION.

If your starting wall is uneven, *refer to Fig 11* to prevent having to uninstall rows.

Taking measurements to ensure you will not have too small a final piece at the end of a row or too narrow a final row in the beginning can save you time and is recommended.

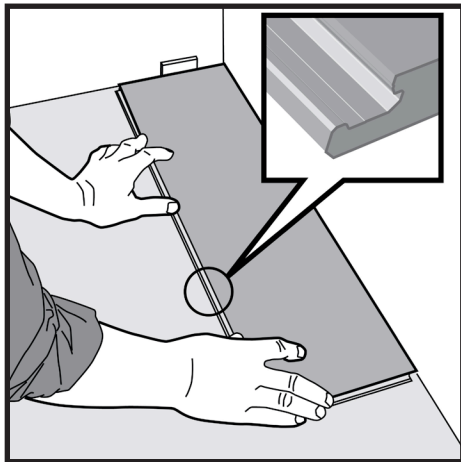

Fig 1.

First plank, first row.

Place the 1st plank a distance of approximately 3/8" away from the wall on the short-side of the plank (use spacers, or a cut piece of one of the planks to help maintain this spacing).

The same 3/8" expansion gap must also be maintained on the long side of each plank. **TIP: It can be easier to install the first 3 rows flush against the wall, pull the 3 joined rows back slightly from the wall, install spacers, and then push the floor against the spacers.**

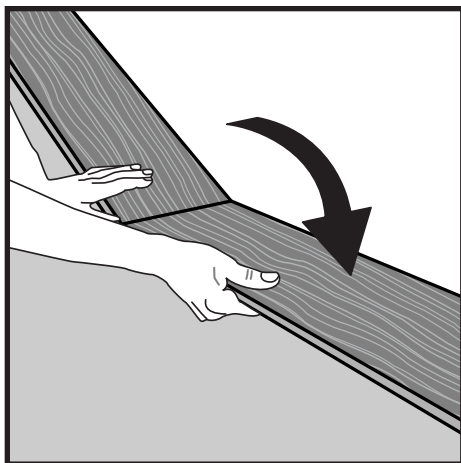

Fig 2.

Second plank, first row.

Press the short end of the next plank at an angle to the first one, making sure the edges are lined up with the first one, then lay down. Complete the first row in the same manner.

LAMINATE FLOORING INSTALLATION INSTRUCTIONS

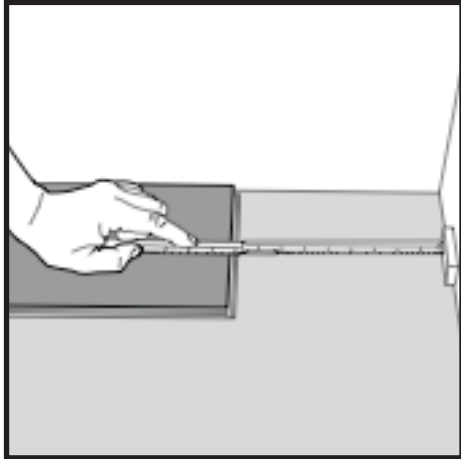

Fig 3.

At the end of the first row, be sure to leave another 3/8" expansion gap between the short end of the plank and the wall. Measure the distance carefully, ensuring proper gap after the plank is cut and joined. The last plank of every row should be a minimum of 12 inches in length.

(See Fig 4. for cutting instructions)

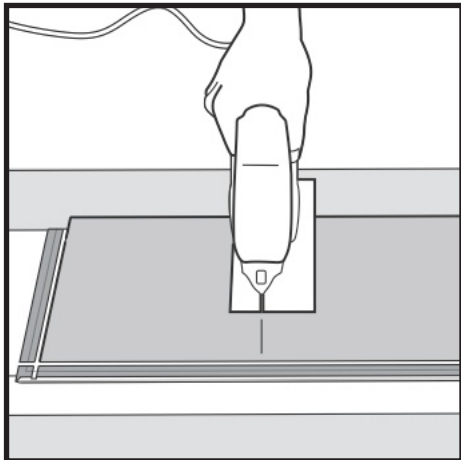

Fig 4.

Planks can be cut with a jig saw, power saw, or hand saw. If using power tools, it is recommended that the décor side of the plank (the side that looks like the floor will look after installation) is facing down. If using a hand saw, the décor should be facing up while cutting.

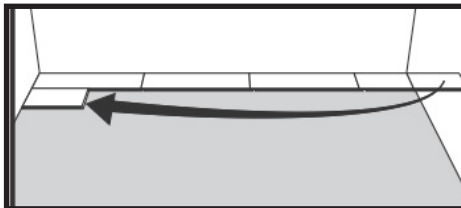

Fig 5.

Second row.

When starting the 2nd row, the short-side seams need to be staggered from the 1st row. Typically, the portion of the plank cut from the last piece in the 1st row can be used to start the 2nd row, although any piece used to start or end a row must be at least 12" in length.

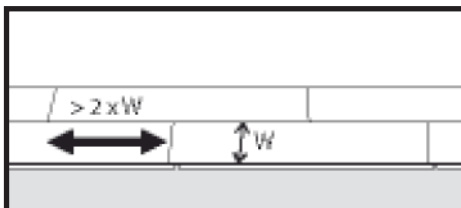

Fig 6.

The Stagger is the distance between short ends from one row to the next and should follow the following: minimum distance between the seams of the short ends of planks in parallel rows shall not be less than 2 times the width of the plank (for example, if a plank is 8" wide, ends should be staggered by at least 16").

LAMINATE FLOORING INSTALLATION INSTRUCTIONS



Fig 7.

Place the floorboard an angle against the floorboard in the previous row, press forward and fold down at the same time. **NOTE: The plank should not be folded all the way to the floor. It must stay slightly raised, until all of the planks in the row are installed.** Only after the entire row is installed, are all the planks pushed fully down at the same time.

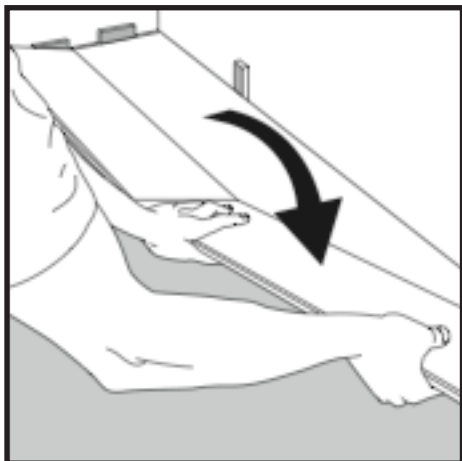

Fig 8.

Second plank second row.

Place the short end of the floorboard at an angle against the previous installed floorboard and fold down.

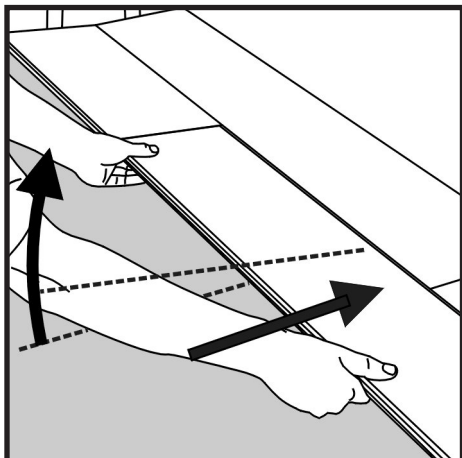

Fig 9.

Angle plank (together with the previous installed in the same row) slightly (about 1") and push it against the row in front. This lift/push will slide the plank into alignment with the plank next to it in the same row, and will engage the glueless click joint. After the planks are fully engaged, allow them to drop back to a natural angle and **DO NOT** push the planks flush with the floor until this angle/push technique is complete for all planks in the row (prematurely pushing the planks down will prevent proper installation of subsequent planks in the row, and may damage product).

LAMINATE FLOORING INSTALLATION INSTRUCTIONS

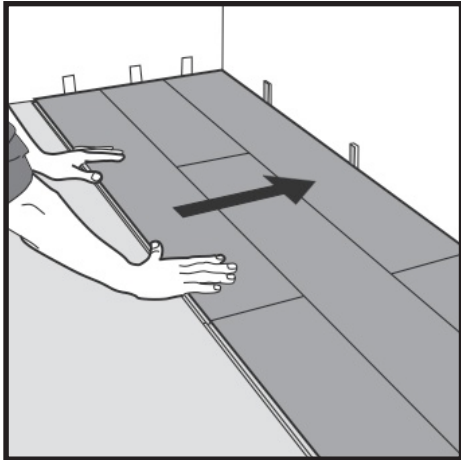

Fig 10.
After 2-3 rows.

Adjust the distance to the front wall by sliding the entire floor back, placing 3/8" spacers against the wall, and sliding the entire floor against the spacers.

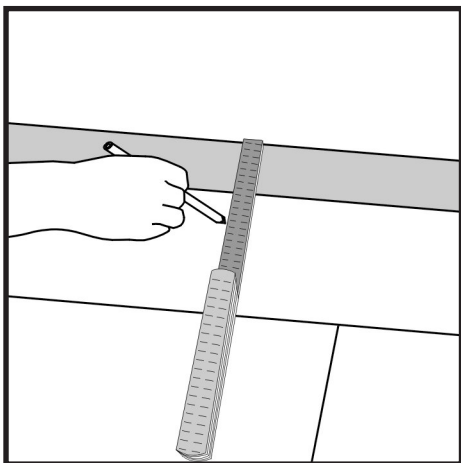

Fig 11.

If the wall is uneven, the planks must be cut to match the "contour" of the wall. Mark the floorboards with the contour of the wall (using a ruler to trace the contour of the wall on the plank). Do not forget to leave the 3/8" expansion gap .

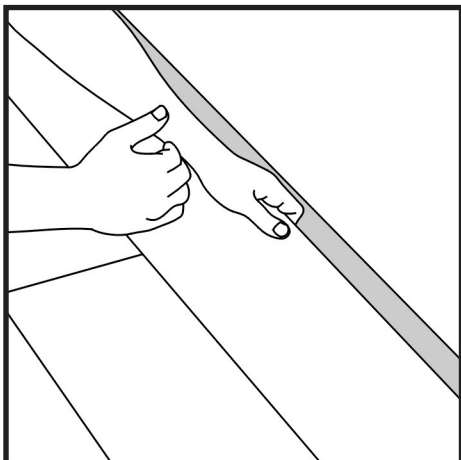

Fig 12.

To remove the first row, lift the floorboard about an inch and tap the planks along the joint. Cut the floorboards as required.

LAMINATE FLOORING INSTALLATION INSTRUCTIONS

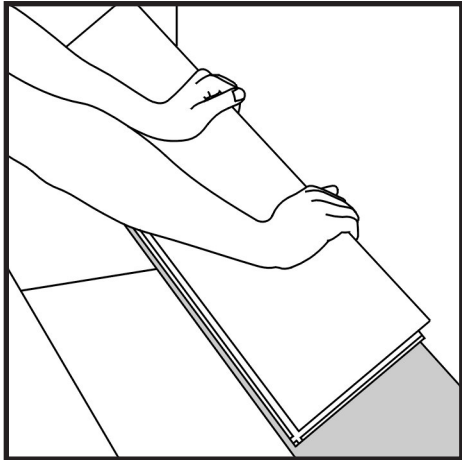

Fig 13.

Reinstall the first row from left to right.

Press the boards against the edge of floorboards that are already in position, with the strip first.

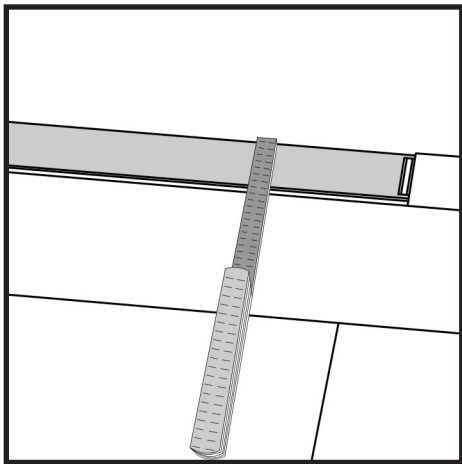

Fig 14.

Last row.

The last row should be no narrower than 2", and must be cut to sufficient width to allow for the 3/8" expansion gap. Use a table saw to rip planks to the appropriate width. If resulting planks would be less than 2", the planks from the 1st row may need to be ripped to width to accommodate wider planks in the last row.

LAMINATE FLOORING INSTALLATION INSTRUCTIONS

HORIZONTAL INSTALLATION (UNDER DOOR JAMS, BASEBOARD HEATERS, ETC.)

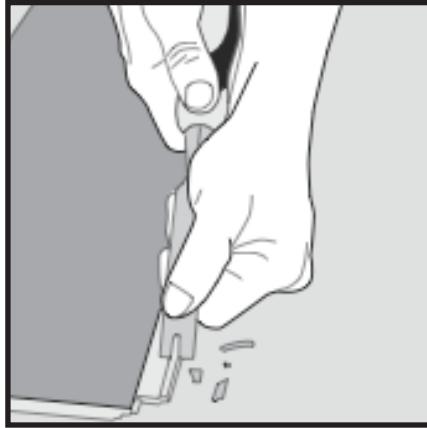

Fig 15.

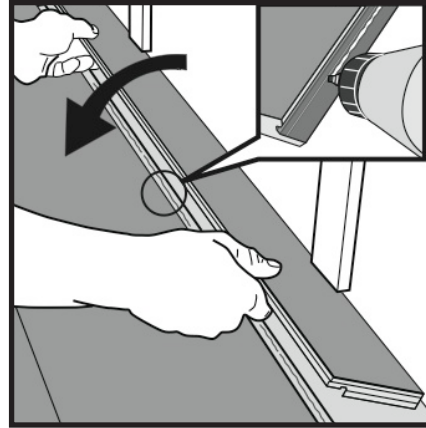

Fig 16.

Cut off the “lip” from the groove using a chisel, knife, or paint scraper. Put a small bead of white glue (PVAc, carpenter’s glue, etc.) on the adjusted groove and push the planks horizontally together. If necessary place some spacers between last board and the wall during the hardening time of the glue. The method can also be applied to the short ends.

RADIATOR PIPES

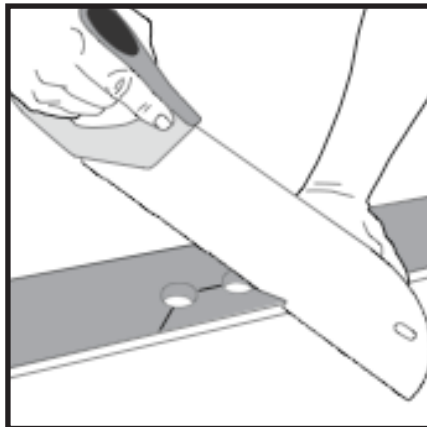

Fig 17.

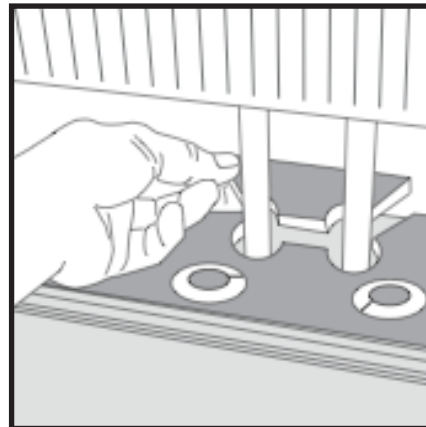

Fig 18.

Mark the center of the holes and drill the hole with $\frac{3}{4}$ ” diameter or larger than the pipe diameter (=10 mm gap around), cut as shown. Install the floor plank. Put white PVAc glue on the cut piece and replace.